

Válečkové řetězy s lomenými články ROTARY - dle DIN 8182 / ANSI API

Rollenketten mit gekröpften Gliedern ROTARY-Ketten - nach DIN 8182 / ANSI API

Roller chains with cranked links ROTARY - to DIN 8182 / ANSI API

Роликовые цепи с гнутыми спецпластинами ROTARY - согласно DIN 8182 / ANSI API

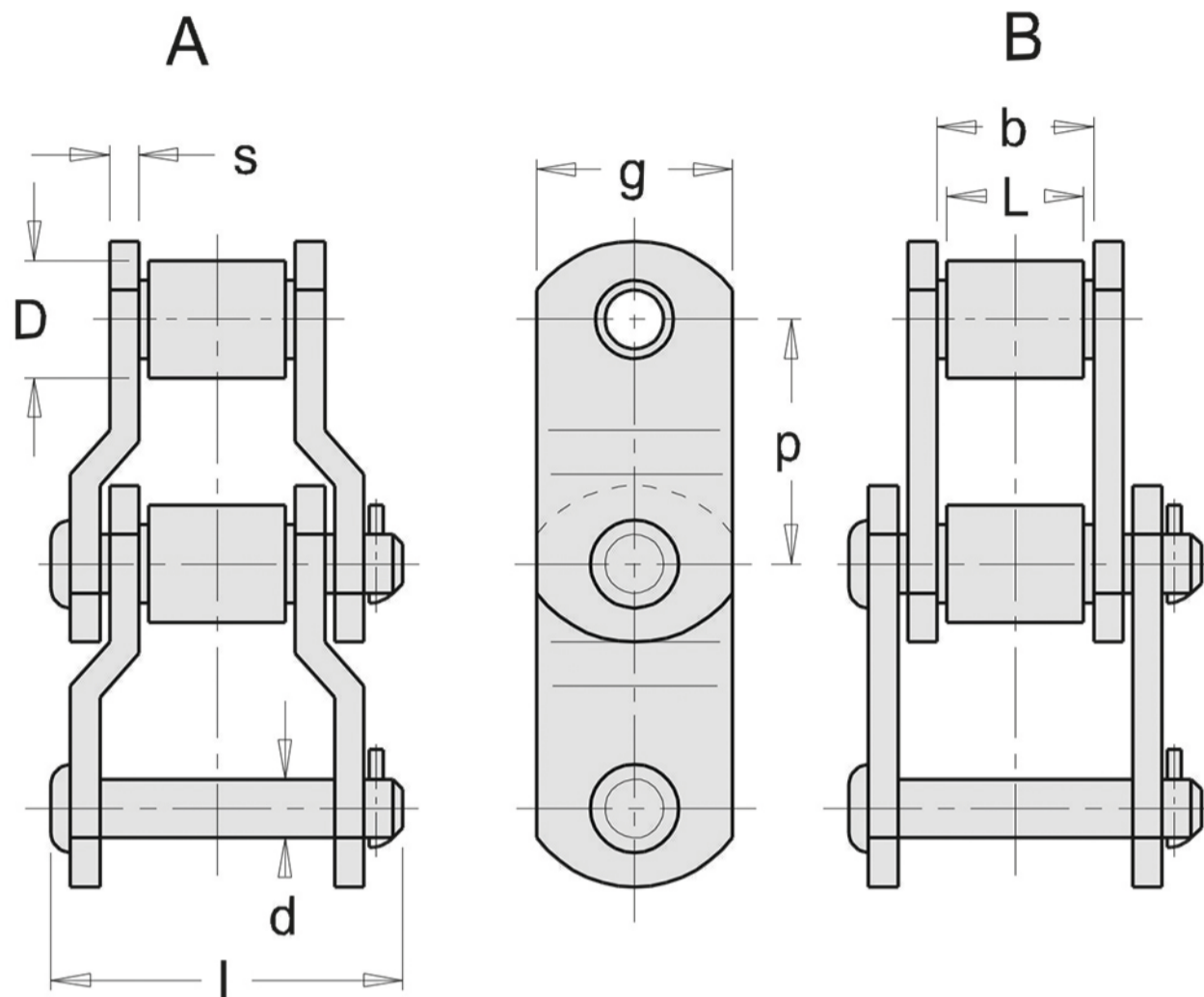

Тов. ozn. Betr. Nr. Firm no. Зав. обозн.	Тур Type Тип	p inch	p mm	b mm min.	d mm	D mm	l mm	g mm	s mm	F _B kN	F _A kN	Q kg/m
RV - TXS 882	A	2,610	66,3	27,5	11,10	22,20	68,0	29	6,3	127	12,7	5,57
RV - 603	A	3,000	76,2	38,0	14,00	-	86,5	40	8,0	240	24,0	9,80
RV - 3067X	A	3,067	77,9	40,0	19,00	41,30	98,7	50	10,0	500	50,0	19,10
RV - 3	A	3,075	78,1	38,1	17,92	31,75	93,0	45	8,0	340	34,0	12,30
RV - 3 PD	B	3,075	78,1	38,0	17,92	31,75	87,0	45	8,0	340	34,0	11,60
RV - 3366	A	3,366	85,5	40,0	19,00	39,50	101,0	50	10	340	34,0	16,57
RV - 3.5	A	3,500	88,9	38,1	23,90	44,45	118,0	60	14,0	680	68,0	27,40
RV - 1664 A	A	4,000	101,6	55,5	30,18	57,15	141,0	82	14,0	1135	113,5	41,40
RV - 4	A	4,063	103,2	49,2	23,92	44,45	129,0	60	14,0	680	68,0	26,40
RV - 4 UP	A	4,063	103,2	49,2	23,92	60,00	129,0	60	14,0	680	68,0	31,00
RV - E 4073	A	4,073	103,4	49,5	25,40	45,20	131,0	60	14,0	771	77,1	27,20
RV - 795	A	4,090	103,89	49,2	25,40	50,80	135,0	70	15,0	900	90,0	31,80
RV - 4.5	A	4,500	114,3	49,2	29,24	57,20	130,0	76	14,0	860	86,0	35,00
RV - 1605 AAA	A	5,000	127,0	64,5	34,90	63,50	168,5	90	19,0	1300	130,0	59,60
RV - 5	A	5,000	127,0	70,0	34,90	63,50	174,0	90	19,0	1300	130,0	60,60
RV - 6	A	6,000	152,4	75,0	38,10	76,20	182,0	100	19,0	1600	160,0	70,00