

# ANSI Standard Roller Chains

SY's precision power transmission roller chains meet or exceed ANSI standard B29.1. Supplied in single and multiple strands of ANSI sizes from 3/8" to 3" pitch.

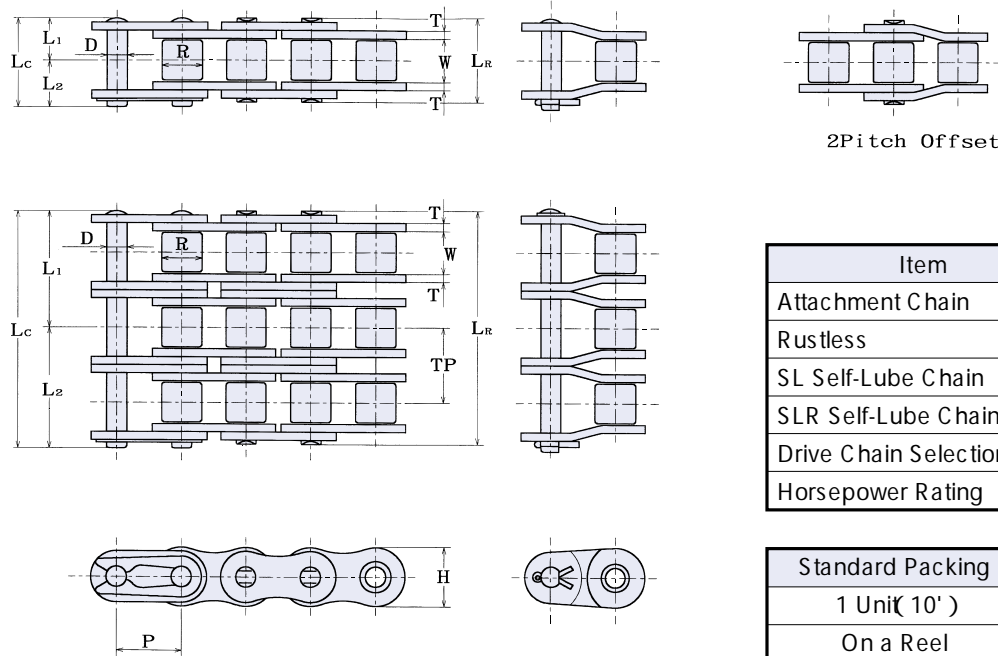

Item	See Page	
Attachment Chain	66	67
Rustless	36	40 43
SL Self-Lube Chain	49	
SLR Self-Lube Chain	52	53
Drive Chain Selection	76	77
Horsepower Rating	82	

Standard Packing	SY35	SY40
1 Uni( 10' )	320P	240P
On a Reel	250'	200'

## 35 (BUSHED CHAIN)

SY Chain No. (ANSI)	Dimensions - mm											Average Ultimate Strength kN	Maximum Allowable Load kN	Average Chain Weight kg/m
	Pitch P	Bushing		Pin				Plate		Trans. Pitch TP				
		Width W	Dia. R	Dia. D	Length		Height H	Thick. T						
					LR	LC	L1	L2						
SY 35	9.525	4.78	5.08	3.58	12.0	12.9	6.0	6.9	9.0	1.25	-	10.8	2.48	0.34
SY 35-2					22.1	23.0	11.1	11.9			10.1	21.6	3.67	0.63
SY 35-3					32.2	33.1	16.1	17.0				32.4	5.40	0.92
SY 35-4					42.3	43.2	21.2	22.0				43.2	7.13	1.22
SY 35-5					52.4	53.2	26.2	27.0				54.0	8.42	1.56
SY 35-6					62.5	63.5	31.3	32.2				64.8	9.94	1.89

## 40

SY Chain No. (ANSI)	Dimensions - mm											Average Ultimate Strength kN	Maximum Allowable Load kN	Average Chain Weight kg/m
	Pitch P	Roller		Pin				Plate		Trans. Pitch TP				
		Width W	Dia. R	Dia. D	Length		Height H	Thick. T						
					LR	LC	L1	L2						
SY 40	12.70	7.95	7.92	3.96	16.5	17.9	8.3	9.6	11.7	1.5	-	19.1	4.17	0.60
SY 40-2					30.8	32.2	15.4	16.8			14.4	38.2	6.17	1.22
SY 40-3					45.0	46.6	22.5	24.1				57.3	9.08	1.85
SY 40-4					60.0	60.8	30.0	30.8				76.4	12.0	2.46
SY 40-5					74.6	75.6	37.3	38.3				95.5	14.2	3.14
SY 40-6					89.0	89.9	44.5	45.4				115.0	16.7	3.31

Refer to page 80. " Selection of offset link "

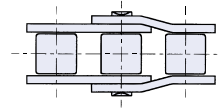
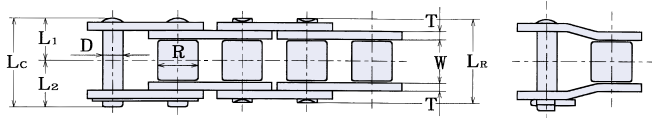

2Pitch Offset

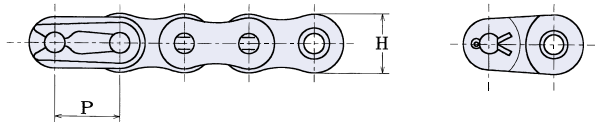
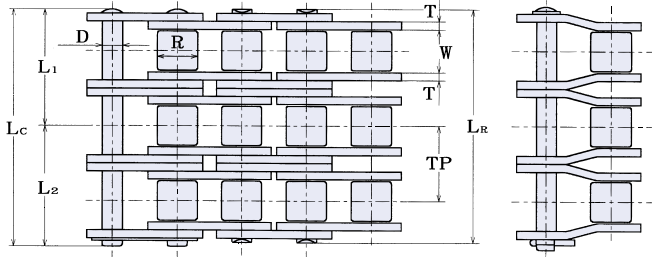

Item	See Page	
Attachment Chain	60	67
Rustless	36	40 43
SL Self-Lube Chain	49	
SLR Self-Lube Chain	52	53
Drive Chain Selection	76	77
Horsepower Rating	82	83

Standard Packing	SY50	SY60
1 Uni( 10' )	192P	160P
On a Reel	100'	100'

50

SY Chain No. (ANSI)	Dimensions - mm											Average Ultimate Strength	Maximum Allowable Load	Average Chain Weight
	Pitch	Rollre		Pin				Plate		Trans. Pitch				
		Width	Dia.	Dia.	Length				Height		Thick.			
		P	W	R	D	LR	LC	L1	L2		H			
SY 50	15.875	9.53	10.16	5.08	20.4	22.0	10.2	11.8	14.6	2.0	-	31.9	7.22	0.98
SY 50-2					38.4	40.0	19.2	20.8			18.1	63.8	10.7	2.00
SY 50-3					56.7	58.2	28.4	29.8				95.7	15.7	3.07
SY 50-4					75.0	75.7	37.5	38.2				128	20.7	3.97
SY 50-5					93.2	94.1	46.6	47.5				160	24.5	5.02
SY 50-6					111.4	112.5	55.7	56.8				191	28.9	6.01

60

SY Chain No. (ANSI)	Dimensions - mm											Average Ultimate Strength	Maximum Allowable Load	Average Chain Weight
	Pitch	Roller		Pin				Plate		Trans. Pitch				
		Width	Dia.	Dia.	Length				Height		Thick.			
		P	W	R	D	LR	LC	L1	L2		H			
SY 60	19.05	12.70	11.91	5.95	25.5	26.9	12.8	14.1	17.5	2.4	-	43.1	10.7	1.46
SY 60-2					48.2	49.7	24.0	25.7			22.8	86.2	14.7	2.95
SY 60-3					71.2	72.6	35.2	37.4				129	21.6	4.43
SY 60-4					94.4	95.4	47.2	48.2				172	28.5	5.92
SY 60-5					117.0	118.2	58.5	59.7				216	33.7	7.41
SY 60-6					140.0	140.9	70.1	70.8				259	39.7	8.90
SY 60-8					185.0	186.6	92.5	94.1				345	53.5	13.36
SY 60-10					230.8	232.2	115.4	116.8				431	64.7	16.34

Refer to page 80. " Selection of offset link "

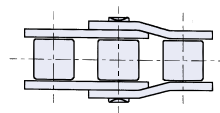
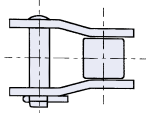
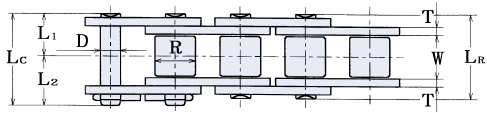

2Pitch Offset

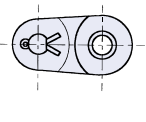
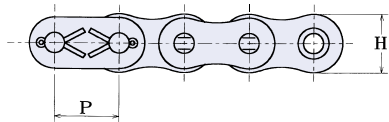
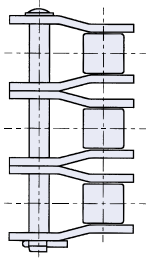
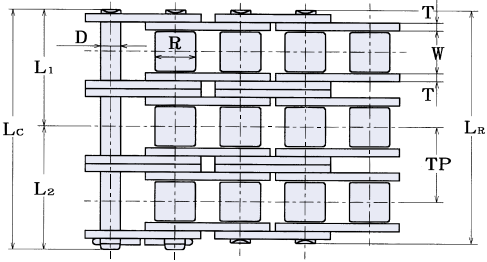

Item	See Page	
Attachment Chain	66	67
Rustless	36	40 43
SL Self-Lube Chain	49	
SLR Self-Lube Chain	52	53
MF Maintenance Free	57	
Drive Chain Selection	76	77
Horsepower Rating	83	

Standard Packing	SY80	SY100
1 Uni( 10' )	120P	96P

80

SY Chain No. (ANSI)	Dimensions - mm											Average Ultimate Strength kN	Maximum Allowable Load kN	Average Chain Weight kg/m
	Pitch P	Roller		Pin				Plate		Trans. Pitch TP				
		Width W	Dia. R	Dia. D	Length		Height H	Thick. T						
					LR	LC	L1	L2						
SY80	25.40	15.88	15.88	7.93	32.8	35.5	16.4	19.1	23.4	3.2	-	78.5	19.1	2.52
SY80-2					61.6	64.5	30.8	33.7			29.3	157	25.0	5.10
SY80-3					90.9	94.1	45.5	48.6				236	36.8	7.68
SY80-4					120.4	123.5	60.2	63.3				314	48.5	10.25
SY80-5					149.8	152.8	74.9	77.9				393	57.3	12.84
SY80-6					179.1	182.1	89.6	92.5				471	67.6	15.42
SY80-8					237.6	240.6	118.8	121.8				628	91.1	20.58
SY80-10					296.2	299.2	148.1	151.1				785	110	25.81

100

SY Chain No. (ANSI)	Dimensions - mm											Average Ultimate Strength kN	Maximum Allowable Load kN	Average Chain Weight kg/m
	Pitch P	Roller		Pin				Plate		Trans. Pitch TP				
		Width W	Dia. R	Dia. D	Length		Height H	Thick. T						
					LR	LC	L1	L2						
SY100	31.75	19.05	19.05	9.53	39.4	43.0	19.7	23.3	29.3	4.0	-	118	29.4	3.91
SY100-2					75.1	78.8	37.6	41.2			35.8	236	38.4	7.74
SY100-3					110.9	114.6	55.5	59.1				354	56.5	11.58
SY100-4					147.4	150.8	73.7	77.1				472	74.6	15.40
SY100-5					183.0	186.6	91.5	95.1				590	88.1	19.26
SY100-6					218.8	222.4	109.4	113.0				708	104	23.10
SY100-8					290.4	294.1	145.2	148.9				944	140	30.81
SY100-10					362.0	365.7	181.0	184.7				1180	170	38.54

Refer to page 80. " Selection of offset link "

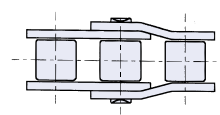
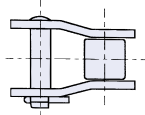
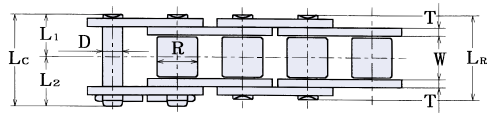

2Pitch Offset

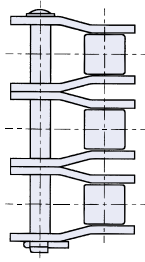
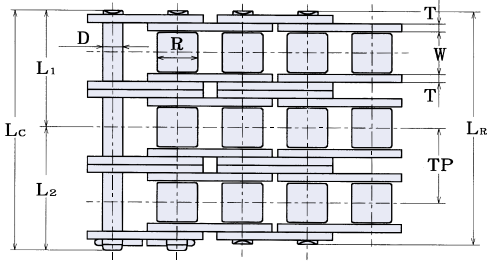

Item	See Page	
Attachment Chain	66	67
Rustless	36	40
SL Self-Lube Chain	49	
MF Maintenance Free	57	
Drive Chain Selection	76	77
Horsepower Ratings	84	

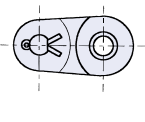
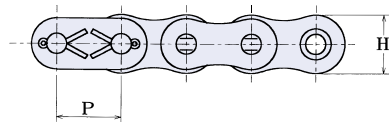

Standard Packing	SY120	SY140
1 Unit(10')	80P	68P

## 120

SY Chain No. (ANSI)	Dimensions - mm											Average Ultimate Strength kN	Maximum Allowable Load kN	Average Chain Weight kg/m
	Pitch P	Roller		Pin				Plate		Trans. Pitch TP				
		Width W	Dia. R	Dia. D	Length		Height H	Thick. T						
					LR	LC	L1	L2						
SY120	38.10	25.40	22.23	11.10	49.5	53.4	24.8	28.6	35.1	4.8	-	167	39.5	5.76
SY120-2					94.9	98.8	47.5	51.3			45.4	334	51.7	11.49
SY120-3					140.3	144.2	70.2	74.0				501	76.0	17.20
SY120-4					186.1	190.0	93.1	96.9				668	100	22.92
SY120-5					231.5	235.4	115.8	119.6				835	119	28.65
SY120-6					276.9	280.8	138.5	142.3				1002	140	34.36
SY120-8					367.5	371.7	183.8	187.9				1336	188	45.81
SY120-10					458.3	462.5	229.2	233.3				1670	228	57.38

## 140

SY Chain No. (ANSI)	Dimensions - mm											Average Ultimate Strength kN	Maximum Allowable Load kN	Average Chain Weight kg/m
	Pitch P	Roller		Pin				Plate		Trans. Pitch TP				
		Width W	Dia. R	Dia. D	Length		Height H	Thick. T						
					LR	LC	L1	L2						
SY140	44.45	25.40	25.4	12.70	54.0	58.3	27.0	31.3	40.9	5.6	-	216	52.3	7.41
SY140-2					102.9	107.2	51.5	55.7			48.9	432	68.3	14.63
SY140-3					151.7	156.3	75.9	80.4				648	101	21.91
SY140-4					201.2	205.5	100.6	104.9				864	133	29.17
SY140-5					250.1	254.4	125.1	129.3				1080	157	36.45
SY140-6					299.0	303.3	149.5	153.8				1296	185	43.72
SY140-8					396.5	401.1	198.3	202.8				1728	249	58.28
SY140-10					494.3	498.9	247.2	251.7				2160	302	72.82

Refer to page 80. " Selection of offset link "

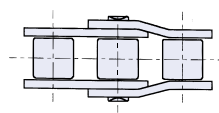
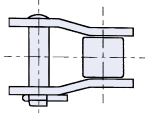
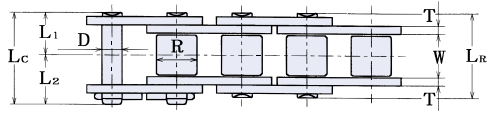

2Pitch Offset

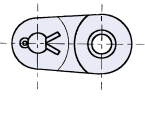
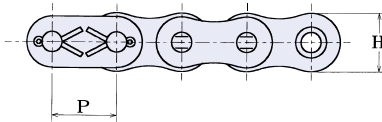
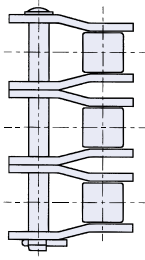
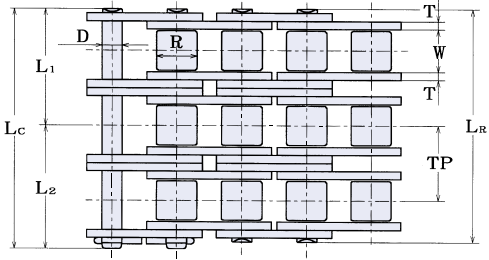

Item	See Page	
Attachment Chain	66	67
Rustless	36	40
SL Self-Lube Chain	49	
MF Maintenance Free	57	
Drive Chain Selection	76	77
Horsepower Ratings	84	85

Standard Packing	SY160	SY180
1 Unit(10')	60P	54P

160

SY Chain No. (ANSI)	Dimensions - mm											Average Ultimate Strength kN	Maximum Allowable Load kN	Average Chain Weight kg/m
	Pitch P	Roller		Pin				Plate		Trans. Pitch TP				
		Width W	Dia. R	Dia. D	Length		Height H	Thick. T						
					LR	LC	L1	L2						
SY160	50.80	31.75	28.58	14.28	64.3	68.7	32.2	36.5	46.7	6.4	-	275	69.0	9.79
SY160-2					122.8	127.2	61.4	65.8			58.5	550	90.1	19.45
SY160-3					181.3	185.7	90.7	95.0				825	133	29.17
SY160-4					240.3	244.7	120.2	124.5				1100	175	38.77
SY160-5					298.8	303.3	149.4	153.9				1375	207	48.43
SY160-6					357.4	361.7	178.7	183.0				1650	244	58.08
SY160-8					474.4	478.8	237.2	241.6				2200	329	77.39
SY160-10					591.4	595.8	295.7	300.1				2750	398	102.86

180

SY Chain No. (ANSI)	Dimensions - mm											Average Ultimate Strength kN	Maximum Allowable Load kN	Average Chain Weight kg/m
	Pitch P	Roller		Pin				Plate		Trans. Pitch TP				
		Width W	Dia. R	Dia. D	Length		Height H	Thick. T						
					LR	LC	L1	L2						
SY180	57.15	35.70	35.70	17.45	72.5	78.4	36.3	42.1	52.5	7.2	-	353	79.0	13.39
SY180-2					138.2	144.0	69.1	74.9			65.8	706	98.4	26.62
SY180-3					204.5	210.2	102.3	107.9				1059	145	39.85
SY180-4					270.2	275.9	135.1	140.8				1412	191	53.08
SY180-5					336.0	341.6	173.6	173.7				1765	226	66.31
SY180-6					401.8	407.3	200.9	206.4				2118	266	79.54

Refer to page 80. " Selection of offset link "

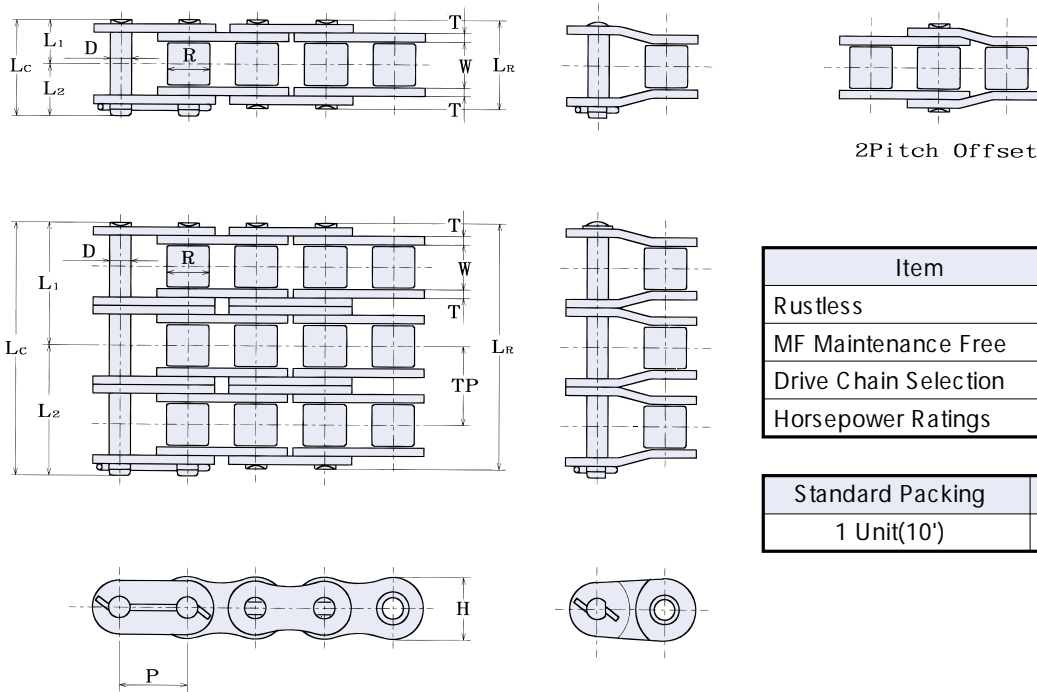

Item	See Page
Rustless	40
MF Maintenance Free	57
Drive Chain Selection	76 77
Horsepower Ratings	85

Standard Packing	SY200	SY240
1 Unit(10')	48P	40P

## 200

SY Chain No. (ANSI)	Dimensions - mm											Average Ultimate Strength kN	Maximum Allowable Load kN	Average Chain Weight kg/m	
	Pitch P	Roller		Pin				Plate		Trans. Pitch TP					
		Width W	Dia. R	Dia. D	Length			Height H	Thick. T						
					\$L_R\$	\$L_c\$	\$L_1\$	\$L_2\$							
SY200	63.50	38.10	39.67	19.83	78.5	87.0	39.3	47.7	59.8	8.0	-	451	93	16.93	
SY200-2						150.2	158.7	75.1	83.6			71.6	902	122	33.73
SY200-3						221.7	230.2	110.9	119.3				1353	179	50.53
SY200-4						293.3	302.4	146.7	155.7				1804	236	67.34
SY200-5						365.5	374.0	182.8	191.2				2255	279	84.14
SY200-6						437.1	445.6	218.6	227.0				2706	329	100.94

## 240

SY Chain No. (ANSI)	Dimensions - mm											Average Ultimate Strength kN	Maximum Allowable Load kN	Average Chain Weight kg/m	
	Pitch P	Roller		Pin				Plate		Trans. Pitch TP					
		Width W	Dia. R	Dia. D	Length			Height H	Thick. T						
					\$L_R\$	\$L_c\$	\$L_1\$	\$L_2\$							
SY240	76.20	47.63	47.63	23.78	96.4	104.1	48.2	55.9	70.3	9.5	-	677	129	23.64	
SY240-2						184.2	191.8	92.1	99.7			87.8	1354	167	47.13
SY240-3						272.0	279.6	136.0	143.6				2031	245	70.61
SY240-4						359.8	367.4	179.9	187.5				2708	324	94.09
SY240-5						447.6	455.2	223.8	231.4				3385	383	117.56
SY240-6						535.5	543.0	267.8	275.2				4062	451	141.06

Refer to page 80. " Selection of offset link "